

SCHEMATIC OF YASHOBHOOMI (IICC), DWARKA, NEW DELHI

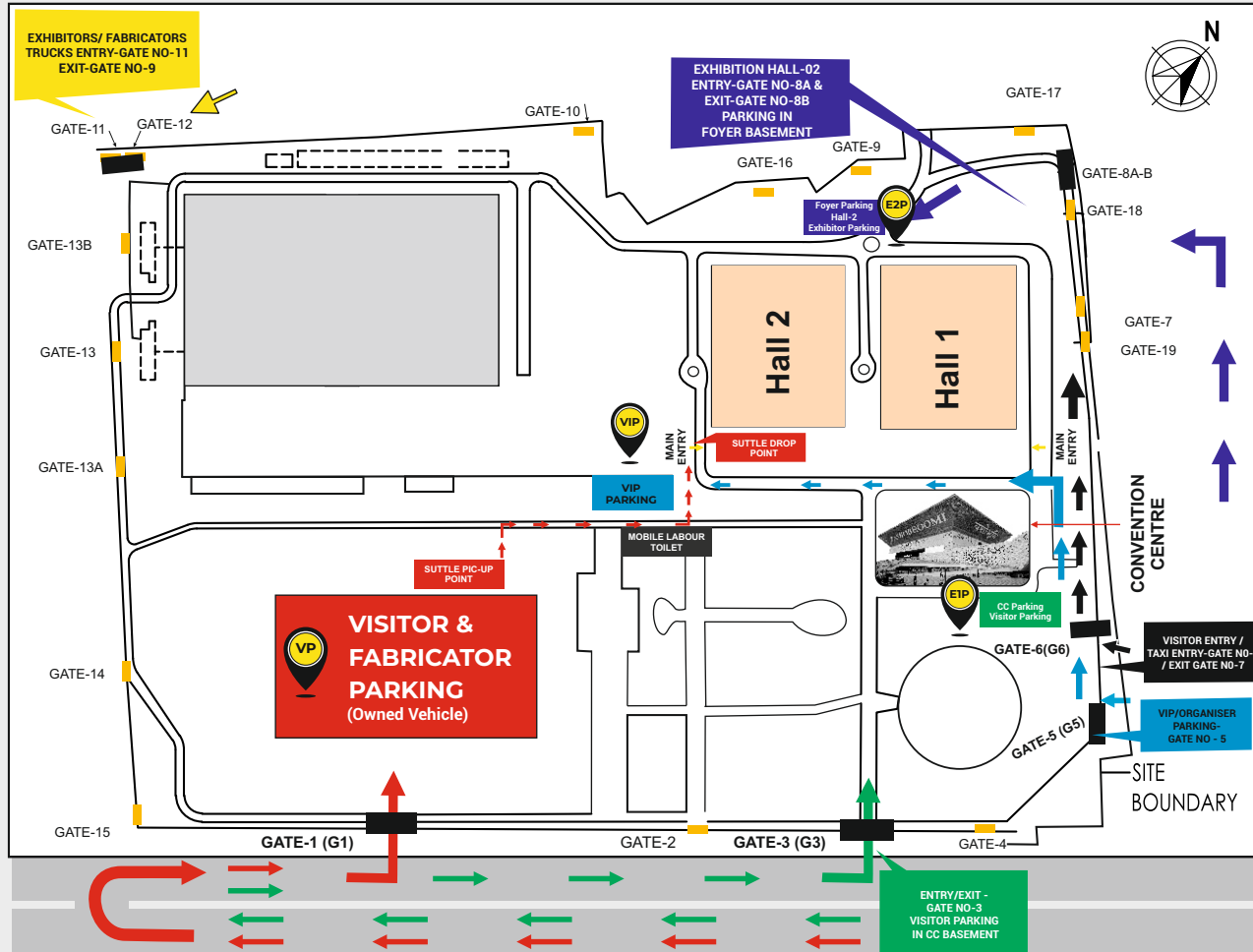

MATECIA[®]

BUILDING MATERIAL EXHIBITION

22 23 24 25 AUG'24

YASHOBHOOMI (IICC), DWARKA, DELHI



ENTRY GATE NO-6 | EXIT NO-7
VISITOR ENTRY /
APP BASED TAXI ENTRY &
EXHIBITOR PARKING IN
FOYER BASEMENT

ENTRY/EXIT - GATE NO-1
VISITOR & FABRICATOR
CAR PARKING (Owned Vehicle)

ENTRY/EXIT - GATE NO-3
HALL-01 VISITOR PARKING
IN CC BASEMENT

**ENTRY-GATE NO-8A &
EXIT-GATE NO-8B**
EXHIBITOR PARKING IN
FOYER BASEMENT

GATE NO - 5
VIP/ORGANISER PARKING

ENTRY GATE NO-11 | EXIT NO-9
EXHIBITORS/ FABRICATORS
TRUCKS PARKING



Parking Details



Visitor & Fabricator Parking (VP)

Enter from Gate No. 3 for
CC Basement Parking **OR**

Enter from gate no. 1 **(G1)**

Park at visitors' parking area **(VP)**

Take Shuttle from **(S1)** and
reach to exhibition area.



For Hall No. 1 Exhibitors Parking (E1P)

Enter from gate no. 6 **(G6)** OR

Enter from gate no. 8A **(G8A)**

Park at foyer parking **(FP)** area



For Hall No. 2 Exhibitors Parking (E2P)

Enter from gate no. 6 **(G6)** OR

Enter from gate no. 8A **(G8A)**

Park at foyer parking **(FP)** area



VIP Parking (VIP)

Enter From Gate No. 5 **(G5)**

Park at VIP parking area **(VIP)**

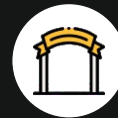

Entry Gate Details

Gate No.1 (G1)

Entry for Visitors and fabricators
with own vehicle

Gate No. 3 (G3)

Entry for Visitors and fabricators
with own vehicle

Gate No. 5 (G5)

Entry for VIPs

Gate No. 6 (G6)

Entry for Visitors

(without vehicle &Taxy),

App Based Taxy &

Entry for Exhibitors with own Vehicle

Gate No.8A (G8A)

Entry for Exhibitors with own Vehicle

Mode 1 (Metro Passengers)

Yashobhoomi Dwarka Sector - 25 Metro Station (Orange Line Metro)

If you are coming from the Airport Metro Line to Yashobhoomi, Dwarka Sector 25 and getting exit from **Gate No. 1**, then you will have to walk about 800 meters underground walkway and you will directly reach to the Exhibition Hall-1.

This line is directly connected from **New Delhi Railway Station** and **Aerocity**.

Sector 21 Metro Station (Blue Line Metro)

If you are coming from Dwarka Sector 21 Metro Station, free shuttle service will be there for all the visitors.

Mode 2 (Taxi Passengers)

Taxis – Direct to IICC (Entry from IICC Gate 6)

Driver Driven Cars (Entry from IICC Gate 6)

Mode 3 (Owned Vehicles Passengers)

Private Vehicles – Direct to Parking of IICC, Entry From Gate No – 1&3 (Shuttle will be available at parking)



ROUTE PLAN

VISITOR & FABRICATOR

22-23-24-25, August 2024



**Self Driven
Visitor Car
Flow &
Parking**



MATECIA[®]

BUILDING MATERIAL EXHIBITION

22 23 24 25 AUG'24

YASHOBHOOMI (IICC), DWARKA, DELHI



ROUTE PLAN

CC PARKING

22-23-24-25, August 2024

**ENTRY/EXIT -
GATE NO-3
VISITOR
PARKING
IN CC BASEMENT**



MATECIA®

BUILDING MATERIAL EXHIBITION

22 23 24 25 AUG'24

YASHOBHOOMI (IICC), DWARKA, DELHI



India
Furniture
CONCLAVE

ROUTE PLAN

EXHIBITOR PARKING

22-23-24-25, August 2024

ENTRY-GATE NO-8A
& EXIT-GATE NO-8B
EXHIBITOR PARKING
IN FOYER BASEMENT



MATECIA[®]

BUILDING MATERIAL EXHIBITION

22 23 24 25 AUG'24

YASHOBHOOMI (IICC), DWARKA, DELHI



ROUTE PLAN

EXHIBITOR PARKING

22-23-24-25, August 2024

ENTRY GATE NO-6 /
EXIT GATE NO-7
VISITOR ENTRY /
APP BASED TAXI
ENTRY & EXHIBITOR
PARKING IN
FOYER BASEMENT



MATECIA®

BUILDING MATERIAL EXHIBITION

22 23 24 25 AUG'24

YASHOBHOOMI (IICC), DWARKA, DELHI

